

Installation Guide

SCMR1232

12 x 32A Relay Controller



iLight

Usk House, Lakeside
Llantarnam Park,
Cwmbran,
NP44 3HD, UK

t: +44 (0)1923 495495
e: enquiries@iLight.co.uk
www.iLight.co.uk

EU Authorised Representative
Cooper Lighting Netherlands B.V.
High Tech Campus
HTC 48
Eindhoven
5656 AE

E&OE. iLight reserve the right to make changes to the equipment without prior notice.
© Signify Holding

Doc No: 9850-000782-03



Dimensions

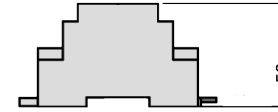
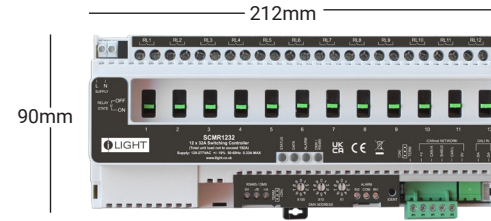

Typical Schematic

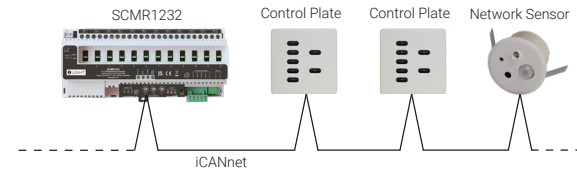

Mounting & Installation

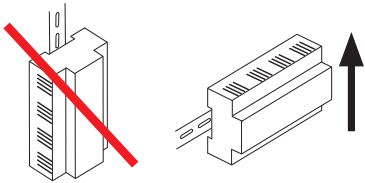

SCMR1232 must be mounted in a suitable enclosure to provide regulatory protection from electric shock hazard as well as protecting the iCANnet data network from tampering that could lead to reduced network security.

Ensure selected enclosure provides adequate cooling ventilation.

Fixing to DIN rail

1. Fix top clips over DIN rail.
2. Pull down bottom clip using screwdriver.
3. Close module towards DIN rail.
4. Push up bottom clip to fix securely to DIN rail.

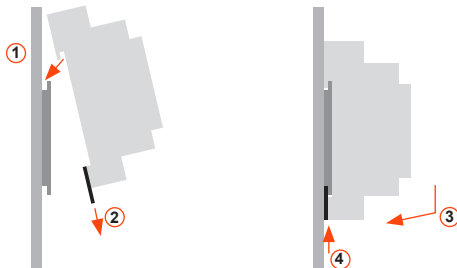

Removing from DIN rail

1. Pull down bottom clip with screwdriver.
2. Lift module away from DIN rail.



Technical Data

Electrical & Mechanical

Control: Via iLight network connection
iCANnet™ output current: 100mA Max @ nominal 15V
Rating: 32A* per channel @ 40°C
Protection: Provided by installer
Output channel current: Maximum 12 x 32A*
(Total unit load not to exceed 192A)

Note: Fully loaded channels should be spaced every other channel to prevent heat buildup

Relay outputs: Volt free capable of switching inductive and resistive loads

Terminal Sizes: Loads - maximum cable size: 1 x 10mm² per circuit

Ambient temperature: 2°C – 40°C

Relative humidity: 5% - 95% max, non-condensing

IP rating: IP20

Installation: Installation must be carried out by a suitably qualified electrician and installed in a suitable DINrail enclosure.

Dimensions: 212mm (w) x 90mm (h) x 58mm (d)

Weight: 0.8kg

Software

For programming SCMR1232, Device Editor V2.11.1 is required
(Packaged with iCANsoft V3.1.7 or later)

* 32A resistive per channel @ 40°C - 20A capacitive per channel @ 40°C



SCMR1232

12 x 32A Relay Controller

Typical Connection Diagram

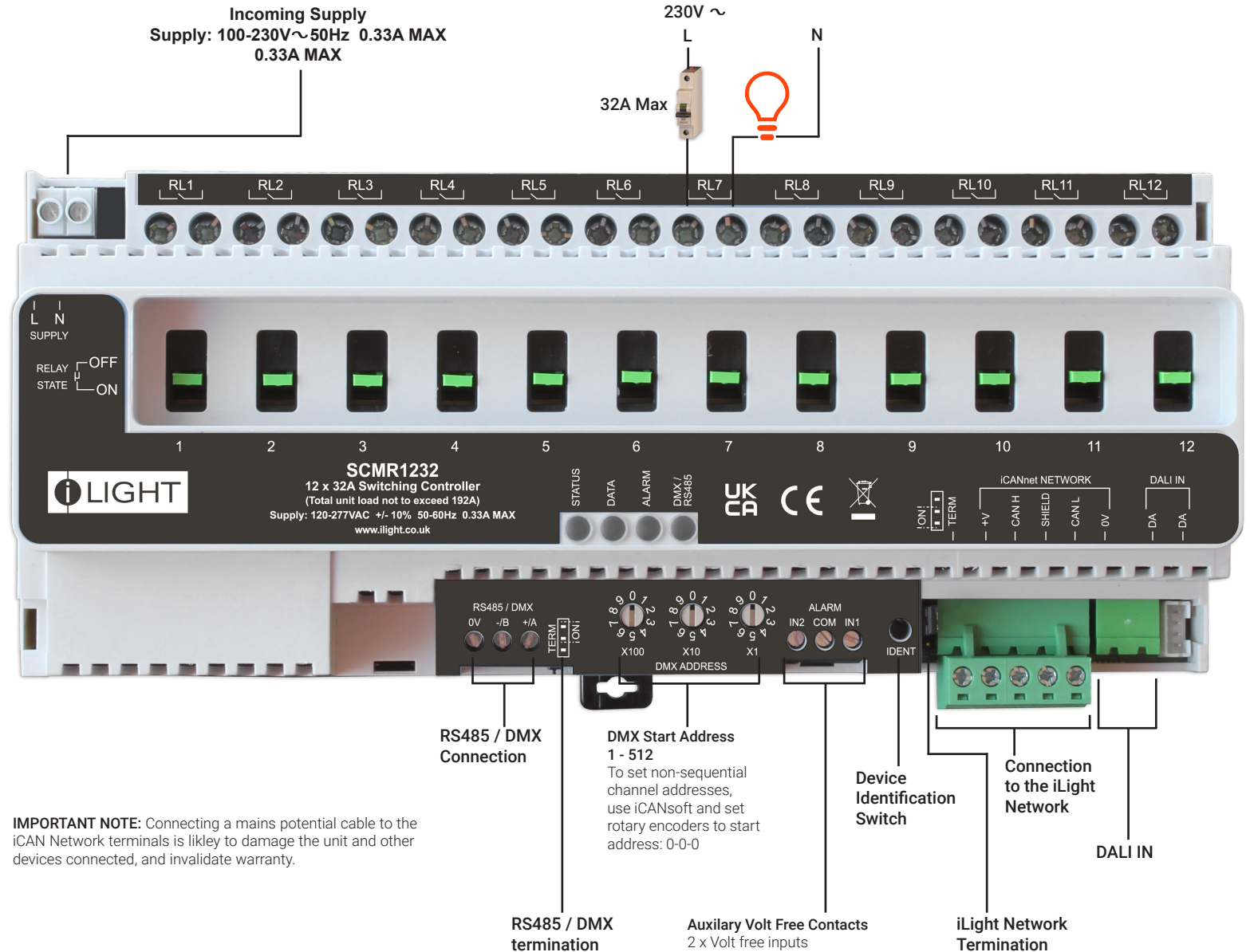

Device LEDs and Buttons

Status LED

Green LED flashes – device OK

Data LED

Red LED flashes when messages sent on network.

Alarm LED

Red LED solid on for local initiated alarm
Red LED flashes for network initiated alarm

RS485 / DMX LED

Green LED flashes when DMX or RS485 messages are sent or received

Device Identification

Press and release switch.
Sending a message to identify the device on the network (red Data LED flashes).

iCAN Network Connections

Function	iCANnet Cable Colours
0V	Black
CAN L	Blue
Shield	Silver
CAN H	White
+VDC	Red

Maximum segment distance: 500m (1640 ft)
Devices per segment: 100 (without bridge or repeater)
Consult iLight for information on alternative cable types.

IMPORTANT NOTE: Connecting a mains potential cable to the iCAN Network terminals is likely to damage the unit and other devices connected, and invalidate warranty.

IMPORTANT NOTE: Connecting a mains potential cable to the iCAN Network terminals is likely to damage the unit and other devices connected, and invalidate warranty.

RS485 / DMX Connection

DMX Start Address 1 - 512
To set non-sequential channel addresses, use iCANsoft and set rotary encoders to start address: 0-0-0

Device Identification Switch

Connection to the iLight Network

DALI IN

RS485 / DMX termination

Auxiliary Volt Free Contacts
2 x Volt free inputs

iLight Network Termination