

Cooper Lighting Solutions

Usk House, Lakeside
Llantarnam Park,
Cwmbran,
NP44 3HD, UK

t: +44 (0)1923 495495
e: info@cooperlighting.co.uk
www.cooperlighting.co.uk

SCMD2

2 Loop Addressable DALI Controller

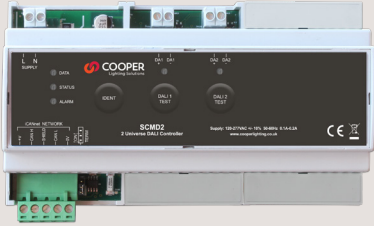

E&OE. iLight reserve the right to make changes to the equipment without prior notice.
© Cooper Lighting Solutions

Document Number: 9850-000771-02



Typical Schematic

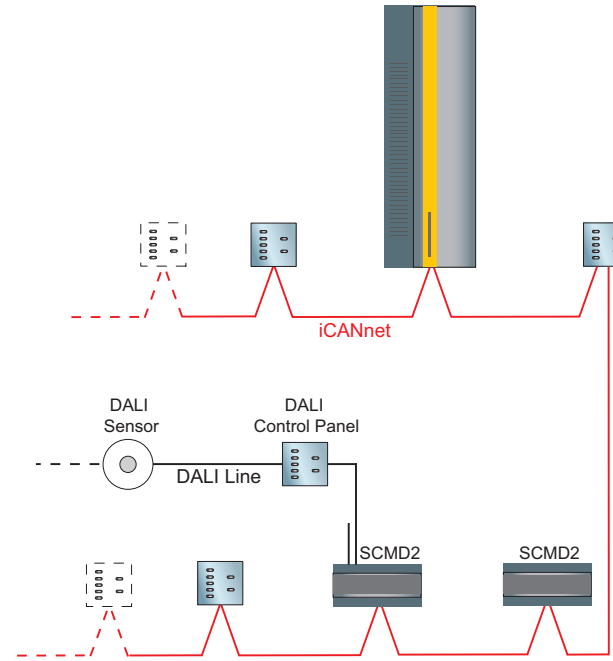

Mounting & Installation

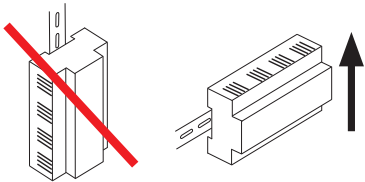

SCMD2 must be mounted in a suitable enclosure to provide regulatory protection from electric shock hazard as well as protecting the iCANnet data network from tampering that could lead to reduced network security.

Ensure selected enclosure provides adequate cooling ventilation.

Fixing to DIN rail

1. Fix top clips over DIN rail.
2. Pull down bottom clip using screwdriver.
3. Close module towards DIN rail.
4. Push up bottom clip to fix securely to DIN rail.

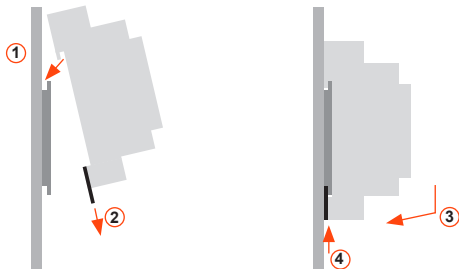

Removing from DIN rail

1. Pull down bottom clip with screwdriver.
2. Lift module away from DIN rail.

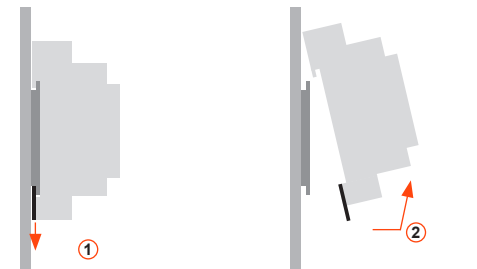

Technical Data

Electrical Data

Supply: 100 - 230VAC +/- 10%, 50/60 Hz
Terminals max. wire size: 2.5mm²
iCANnet™ inputs/output: Screw terminals
iCANnet™ output current: 300mA Max @ nominal 15V
DALI output screw terminals: Max wire size 2.5mm²
DALI signal: Nominal 16V, max current 250mA supplies to each universe.
Guaranteed minimum current: 245mA.
Short circuit protection in accordance with section 6.6.2 of IEC FDIS 62386-101.
Terminals max wire size: 1 x 2.5mm² or 2 x 1.5mm² per circuit
Protection: Provided by installer

Mechanical Data

Weight: 0.35 kg
Operating temperature: +2°C to +50°C
Max storage temperature: +60°C
Humidity: +5 to 95% non-condensing
Environmental protection: IP20

Installation: Installation must be carried out by a suitably qualified electrician and installed in a suitable DINrail enclosure rated for the intended environment.

SCMD2

2 Loop Addressable DALI Controller

Device LEDs and Buttons

Status LED

Green LED flashes – device OK

Data LED

Red LED flashes when messages sent on network.

Alarm LED

Red LED flashes for network initiated alarm

Device Identification

Press and release switch.
Sending a message to identify the device on the network (red Data LED flashes).

DALI LEDs

Yellow LED flashes when messages sent on DALI bus
Yellow LED solid on - short circuit on DALI bus

DALI Loop Test buttons

10 second press to enter Test mode
Sequential presses Broadcast all on all off
10 second press to exit Test mode.

iCAN Network Connections

Function	iCANnet Cable Colours
0V	Black
CAN L	Blue
Shield	Silver
CAN H	White
+VDC	Red

Maximum segment distance: 500m (1640 ft)
Devices per segment: 100 (without bridge or repeater)
Consult iLight for information on alternative cable types.

IMPORTANT NOTE: Connecting a mains potential cable to the iCAN Network terminals is likely to damage the unit and other devices connected, and invalidate warranty.

Typical Connection Diagram

Incoming Supply 120 - 277V AC

Mains supply protection:
Provided by installer (6A Type C MCB recommended)

