

Introduction

The TSG40 is a flexible device that provides an intuitive “user friendly” method of interfacing to the iLight lighting, shading and HVAC control system.

TSG40 comes with an integrated temperature sensor which can be used as an alternative to remote sensors.

Supplied Parts

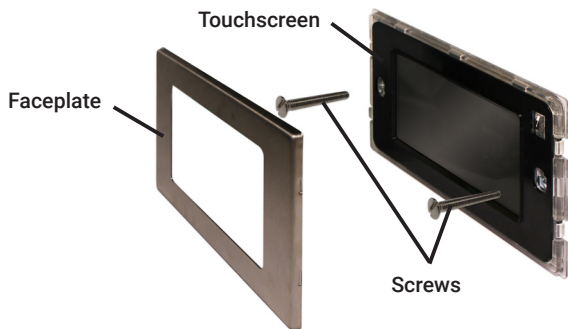

Location

If using the on-board temperature sensor within the TSG40 as the control sensor, please ensure the touchscreen is mounted in a position that best represents the comfort conditions of the space.

Mount away from any windows and doors that could create a heat or cool source and skew the temperature reading. The TSG40 should be mounted away from direct sun light, draughts and other heating or cooling equipment such as radiators or fan coil air supply streams.

If it is not possible to mount the TSG40 in a suitable place for air temperature monitoring, a remote sensor is recommended.

Care and Maintenance

The front cover plate should only be cleaned gently with a clean, ‘dry to damp’ cloth. Abrasive cleaners, polishes, solvent based cleaning agents, or alkali based cleaners should not be used.

Fixing to a wallbox

The touchscreen fits into a standard 35mm deep UK double gang backbox (not supplied)

To avoid damage to the display, it is recommended that the touchscreen is installed after painting/wallpapering has been done.



Remove faceplate to reveal wall fixing holes

Connecting the touchscreen

Power & Network Connection

Connection to the TSG40 is made by a single CAT5e / CAT6 data cable with RJ45 connectors providing power and communications from the HVAC-1.

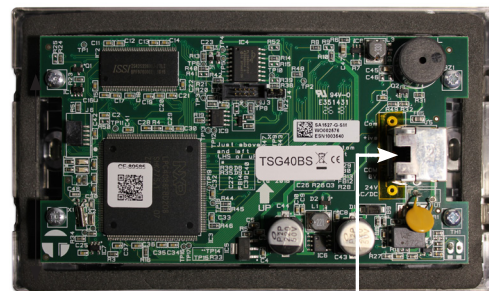

RJ45 Connection to HVAC-1

Dimensions

