

## Cooper Lighting Solutions

Usk House, Lakeside  
Llantarnam Park,  
Cwmbran,  
NP44 3HD, UK

t: +44 (0)1923 495495  
e: info@cooperlighting.co.uk  
www.cooperlighting.co.uk

E&OE. iLight reserve the right to make changes to the equipment without prior notice.  
© Cooper Lighting Solutions

Doc No: 9850-000808-00



## SCMI0402

4 x 500W Triac Dimmer

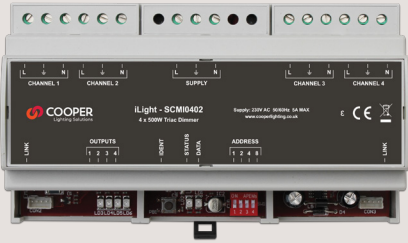

## Typical Schematic

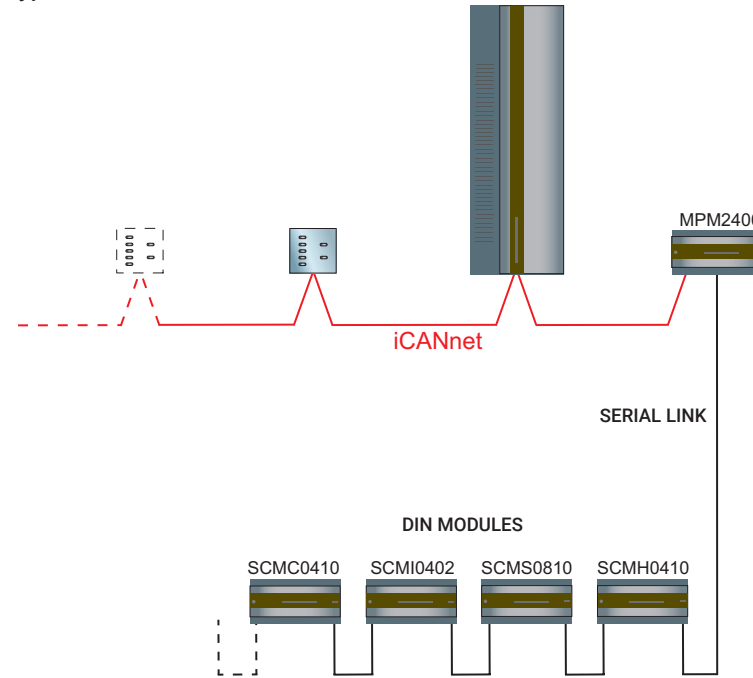

## Mounting & Installation

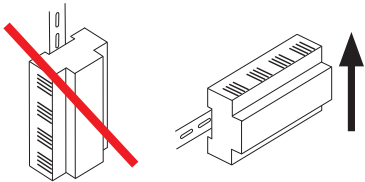

SCMI0402 must be mounted in a suitable enclosure to provide regulatory protection from electric shock hazard as well as protecting the iCANnet data network from tampering that could lead to reduced network security.

Ensure selected enclosure provides adequate cooling ventilation.

### Fixing to DIN rail

1. Fix top clips over DIN rail.
2. Pull down bottom clip using screwdriver.
3. Close module towards DIN rail.
4. Push up bottom clip to fix securely to DIN rail.

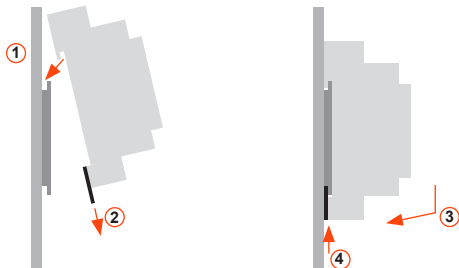

### Removing from DIN rail

1. Pull down bottom clip with screwdriver.
2. Lift module away from DIN rail.

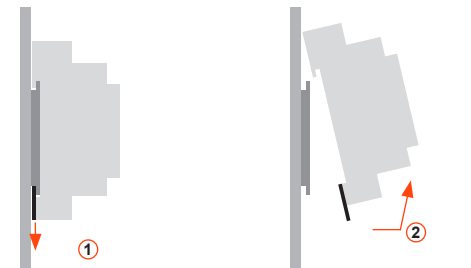

## Technical Data

### Electrical & Mechanical

Supply: 230VAC +/- 10%, 50/60 Hz  
Incoming terminals: maximum cable size: 2.5mm<sup>2</sup>  
Rating: Maximum 5A single phase @ 40°C  
Protection: Provided by installer  
Output channel load: Minimum 20W, maximum 500W per Heatsink  
Load Types: Incandescent 230VAC lamps  
Inductive wire-wound transformers (allow for 20% transformer losses) Leading edge electronic transformers and cold cathode lamps (consult iLight for true load guidance)  
Switched outputs: Dimmed outputs can be configured as switches for non-dimmed loads.  
Not suitable for switching discharge lamps.

### Communications

SCMI0402 requires connection to MPM2400 primary controller to operate Module Link Connections  
Use cable supplied with unit. See diagram for installation  
Terminal Sizes:  
Loads - maximum cable size: 1 x 2.5mm<sup>2</sup> or 2 x 1.5mm<sup>2</sup> per circuit

### Safety

Ambient temperature: 2°C – 40°C  
Relative humidity: 5% - 95% max, non-condensing  
IP rating: IP20  
Installation: Installation must be carried out by a suitably qualified electrician

# SCMI0402

4 x 500W Triac Dimmer

## Typical Connection Diagram

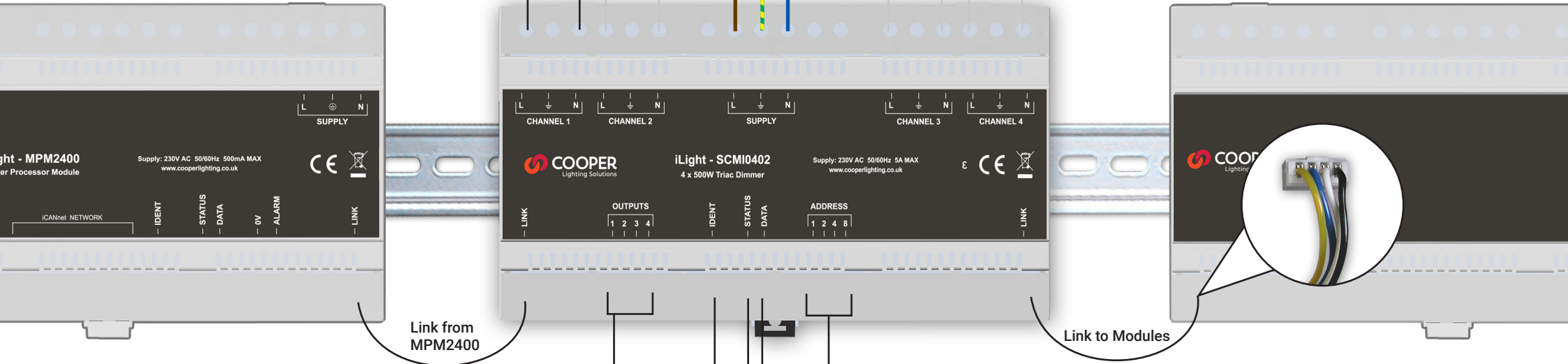

**Ident Switch and LEDs**

**Normal Running Mode**  
 Green LED flashes – device OK  
 Red LED flashes when messages sent on network.

**Device Identification**  
 Press and release switch.  
 Sending a message to identify the device on the network (red LED flashes).  
 Red LED flashes at 2Hz when the unit has an error.

**Entering Override Mode**  
 Press and hold switch for 10 seconds.  
 When in Override mode the green LED flashes twice as fast and the red LED shows the output state. ie red LED off denotes all outputs off, red LED on denotes all output on.

**Override Mode**  
 Short push of switch - all circuits on.  
 Short push of switch - all circuits off.

**Exiting Override Mode**  
 Press and hold switch for 10 seconds or cycle power. Green LED flashes.

**Output LEDs**  
 Signify output level for each channel

