

Installation Guide

iLight

Usk House, Lakeside
Llantarnam Park,
Cwmbran,
NP44 3HD, UK

t: +44 (0)1923 495495
e: enquiries@iLight.co.uk
www.iLight.co.uk

EU Authorised Representative
Cooper Lighting Netherlands B.V.
High Tech Campus
HTC 48
Eindhoven
5656 AE

E&OE. iLight reserve the right to make changes to the equipment without prior notice.
© Signify Holding

Doc No: 9850-000778-01

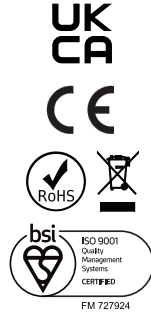

Dimensions

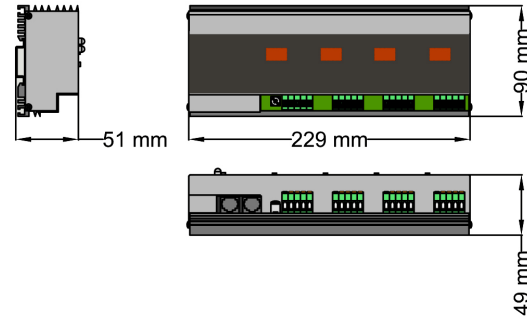

Typical Schematic

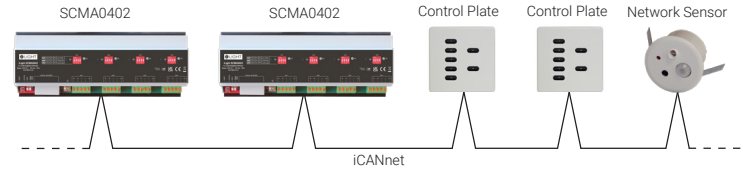

iLight SCMA0402

4 Channel Adaptive Dimmer
DINrail Mount



Mounting & Installation

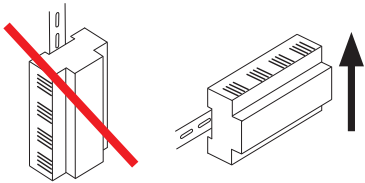

SCMA0402 must be mounted in a suitable enclosure to provide regulatory protection from electric shock hazard as well as protecting the iCANnet data network from tampering that could lead to reduced network security.

Ensure selected enclosure provides adequate cooling ventilation.

Fixing to DIN rail

1. Fix top clips over DIN rail.
2. Pull down bottom clip using screwdriver.
3. Close module towards DIN rail.
4. Push up bottom clip to fix securely to DIN rail.

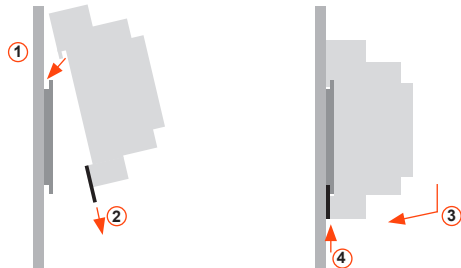

Removing from DIN rail

1. Pull down bottom clip with screwdriver.
2. Lift module away from DIN rail.



Technical Data

Electrical & Mechanical

Supply: 230VAC +/- 10%, 50/60 Hz
Incoming terminals: maximum cable size: 2.5mm²
Rating: Maximum 10A single phase @ 40°C
Protection: Provided by installer
Output channel load: Maximum 575W
Load Types: incandescent, inductive, leading & trailing edge
Terminal Sizes: 1 x 2.5mm² per channel

Communications

Cable Specification: CAT5 FTP terminated with RJ45 connectors

Safety

Ambient temperature: 2°C - 40°C
Relative humidity: 5% - 80% max, non-condensing
IP rating: IP20
Installation: Installation must be carried out by a suitably qualified electrician

SCMA0402

Adaptive Dimmer

Typical Connection Diagram

	OFF	OFF	OFF	OFF	Auto 'Default'	Universal dimmer mode: The dimmer starts in trailing edge mode and switches over to leading edge mode if it recognizes an inductive load and back to trailing edge mode for capacitive load. The dimmer mode stays constant even after an interruption of the mains.
	OFF	OFF	ON	OFF	LED 0-100% Trailing Edge	LED-lamp trailing edge, 0 to 100%: The dimmer brings immediately the requested value between 0 and 100%. For retrofit LED-lamps and incandescent lamps.
	OFF	ON	ON	OFF	LED 0-100% Leading Edge	LED-lamp leading edge, 0 to 100%: The dimmer brings immediately the requested value between 0 and 100%. For retrofit LED-lamps, incandescent lamps.

CAUTION

***Avoid Channel Damage**
If unsure of mode type, set DIP switches to Auto 'Default'

Channel Output Status

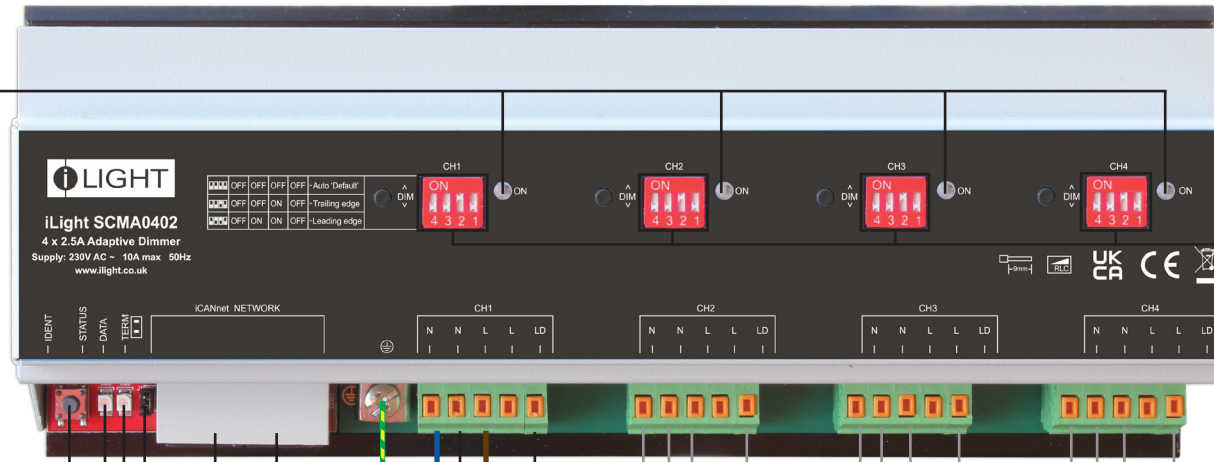

Ident Switch
Status LED
Data LED

iLight Network Termination
Note: Remove termination jumper when SCMA is not the network end device

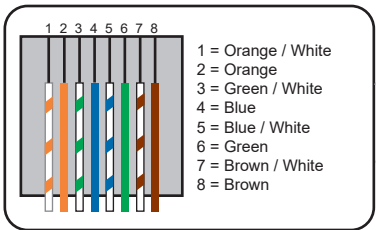

iCAN network connections via RJ45.
Use CAT 5e/Cat6 for the interconnection of devices within an enclosure for speed and convenience.
Use recommended network cable only for field network cabling.

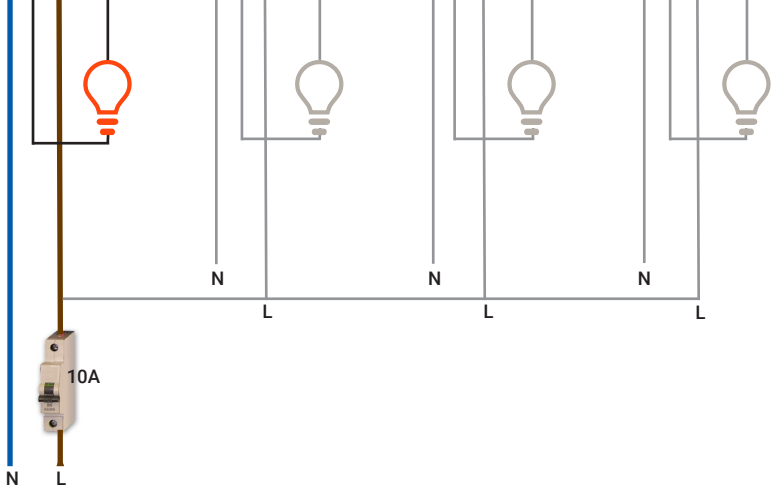

Ident Switch and LEDs

Normal Running Mode
Green LED flashes – device OK
Red LED flashes when messages sent on network.

Device Identification
Press and release switch.
Sending a message to identify the device on the network (red LED flashes).

iCANnet fault
Red LED is on constantly.

Entering Override Mode
Press and hold switch for 10 seconds.
When in Override mode red and green LEDs flash simultaneously.

Override Mode
Switch press to toggle all circuits on then all circuits off

Exiting Override Mode
Press and hold switch for 10 seconds or cycle power.
Green LED flashes.

Channel Output Status LEDs
Signify output level for each channel