

# Installation Guide

## SCMH1200 12 Channel DINrail Mount HF Controller



### iLight

Usk House, Lakeside  
Llantarnam Park,  
Cwmbran,  
NP44 3HD, UK

t: +44 (0)1923 495495  
e: enquiries@iLight.co.uk  
www.iLight.co.uk

**EU Authorised Representative**  
Cooper Lighting Netherlands B.V.  
High Tech Campus  
HTC 48  
Eindhoven  
5656 AE

E&OE. iLight reserve the right to make changes to the equipment without prior notice.  
© Signify Holding

Doc No: 9850-000779-01



### Dimensions

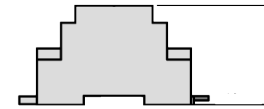

### Typical Schematic

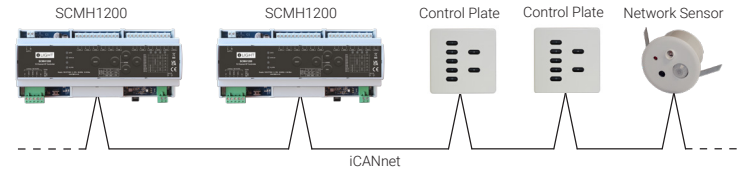

### Mounting & Installation

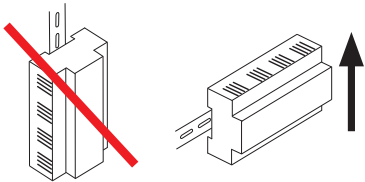

SCMH1200 must be mounted in a suitable enclosure to provide regulatory protection from electric shock hazard as well as protecting the iCANnet data network from tampering that could lead to reduced network security.

Ensure selected enclosure provides adequate cooling ventilation.

#### Fixing to DIN rail

1. Fix top clips over DIN rail.
2. Pull down bottom clip using screwdriver.
3. Close module towards DIN rail.
4. Push up bottom clip to fix securely to DIN rail.

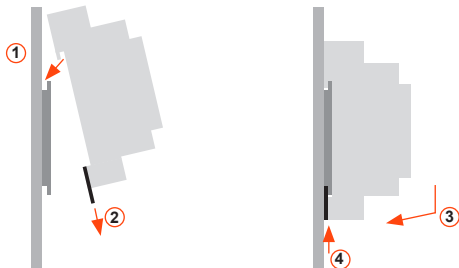

#### Removing from DIN rail

1. Pull down bottom clip with screwdriver.
2. Lift module away from DIN rail.

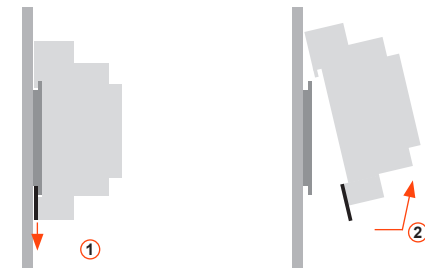

### Technical Data

**Supply:** 100-230V ~50Hz 0.1-0.2A

**Control:** Via iLight network connection or DALI BUS connection.

**iCANnet™ output current:** 500mA Max @ nominal 15V

**Rating:** There is no load control.

**Protection:** Provided by installer

**Supported Load Types:**

DALI (Broadcast), source, 100 mA per channel

DSI, source, 100 mA per channel

0-10V, source, 50 mA per channel

1-10V, sink, 50 mA per channel

**Recommended quantities of drivers/ballasts:**

Maximum of 50 per channel

Maximum of 500 per SCMH1200 unit

**Switched Outputs:** None

**Terminal Sizes:** Incoming supply, max' cable size: 2.5mm<sup>2</sup>.

Ballast output, max' cable size: 2.5mm<sup>2</sup> per terminal

iCAN network cable type: Belden 1502 or equivalent

**Ambient temperature:** 2°C – 50°C

**Relative humidity:** 5% - 95% max, non-condensing

**IP rating:** IP20

**Installation:** Installation must be carried out by a suitably qualified electrician and installed in a suitable DINrail enclosure rated for the intended environment.

**Dimensions:** 212mm (w) x 90mm (h) x 58mm (d)

**Weight:** 0.35kg

#### Software

For programming SCMH1200, Device Editor V2.11.1 or later is required (Packaged with iCANsoft V3.1.7 or later)

# SCMH1200

## 12 Channel DINrail Mount HF Controller

### Device LEDs and Buttons

#### Status LED

Green LED flashes – device OK

#### Data LED

Red LED flashes when messages sent on network.

#### Alarm LED

Red LED flashes for network initiated alarm

#### Device Identification

Press and release switch.

Sending a message to identify the device on the network (red Data LED flashes).

### iCAN Network Connections

Function	iCANnet Cable Colours
0V	Black
CAN L	Blue
Shield	Silver
CAN H	White
+VDC	Red

Maximum segment distance: 500m (1640 ft)  
 Devices per segment: 100 (without bridge or repeater)  
 Consult iLight for information on alternative cable types.

#### Network Power Requirements

Nominal operating voltage: 15V (12-18V)

**IMPORTANT NOTE:** Connecting a mains potential cable to the iCAN Network terminals is likely to damage the unit and other devices connected, and invalidate warranty.

### Network termination

SCMH1200 is supplied with termination disabled as standard. If it is connected as an end device on the iCAN network, the jumper will need to be moved to enable termination.

To enable termination, move the jumper outwards from the inner two pins to the outer two pins.

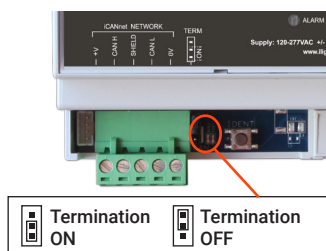

### Typical Connection Diagram

