

## Cooper Lighting Solutions

Usk House, Lakeside  
Llantarnam Park,  
Cwmbran,  
NP44 3HD, UK

t: +44 (0)1923 495495  
e: info@cooperlighting.co.uk  
www.cooperlighting.co.uk

E&OE. iLight reserve the right to make changes to the equipment without prior notice.  
© Cooper Lighting Solutions

Doc No: 9850-000781-01



## SCMR0432

4 x 32A Relay Controller



## Typical Schematic

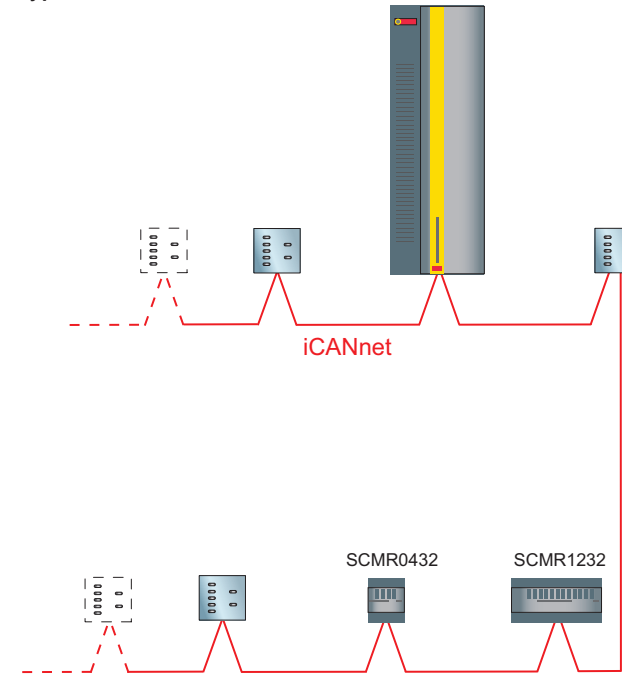

## Mounting & Installation

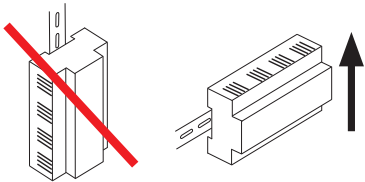

**SCMR0432 must be mounted in a suitable enclosure to provide regulatory protection from electric shock hazard as well as protecting the iCANnet data network from tampering that could lead to reduced network security.**

**Ensure selected enclosure provides adequate cooling ventilation.**

### Fixing to DIN rail

1. Fix top clips over DIN rail.
2. Pull down bottom clip using screwdriver.
3. Close module towards DIN rail.
4. Push up bottom clip to fix securely to DIN rail.

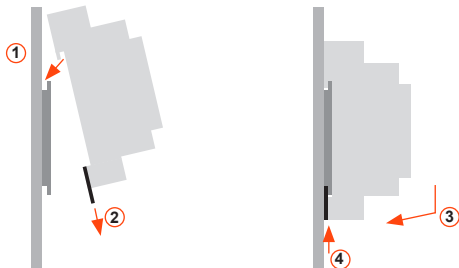

### Removing from DIN rail

1. Pull down bottom clip with screwdriver.
2. Lift module away from DIN rail.



## Technical Data

### Electrical & Mechanical

Control: Via iLight network connection

Rating: 32A\* per channel @ 40°C

Protection: Provided by installer

Output channel current: Maximum 4 x 32A\*  
(Total unit load not to exceed 64A)

Note: Fully loaded channels should be spaced every other channel to prevent heat buildup

Relay outputs: Volt free capable of switching inductive and resistive loads

Terminal Sizes: Loads - maximum cable size: 1 x 10mm<sup>2</sup> per circuit

Ambient temperature: 2°C – 40°C

Relative humidity: 5% - 95% max, non-condensing

IP rating: IP20

Installation: Installation must be carried out by a suitably qualified electrician and installed in a suitable DINrail enclosure.

Dimensions: 73mm (w) x 90mm (h) x 58mm (d)

Weight: 0.8kg

### Software

For programming SCMR0432, Device Editor V2.11.1 is required (Packaged with iCANsoft V3.1.7 or later)

\* 32A resistive per channel @ 400C - 20A capacitive per channel @ 400C

# SCMR0432

4 x 32A Relay Controller

## Device LEDs and Buttons

### Status LED

Green LED flashes – device OK

### Data LED

Red LED flashes when messages sent on network

### Alarm LED

Red LED solid on for local initiated alarm  
Red LED flashes for network initiated alarm

### Device Identification

Press and release switch.  
Sending a message to identify the device on the network  
(red Data LED flashes)

## iCAN Network Connections

Function	iCANnet Cable Colours
0V	Black
CAN L	Blue
Shield	Silver
CAN H	White
+VDC	Red

Maximum segment distance: 500m (1640 ft)  
Devices per segment: 100 (without bridge or repeater)  
Consult iLight for information on alternative cable types.

**IMPORTANT NOTE:** Connecting a mains potential cable to the iCAN Network terminals is likley to damage the unit and other devices connected, and invalidate warranty.

### Network Power Requirements

Nominal operating voltage: 15V (12-18V)  
Nominal operating current: 50mA

## Typical Connection Diagram

