

## Cooper Lighting Solutions

Usk House, Lakeside  
Llantarnam Park,  
Cwmbran,  
NP44 3HD, UK

t: +44 (0)1923 495495  
e: info@cooperlighting.co.uk  
www.cooperlighting.co.uk

## SCMA0402

DINrail Mount  
Adaptive Dimmer

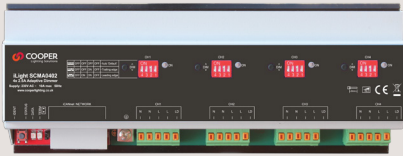

E&OE. iLight reserve the right to make changes to the equipment without prior notice.  
© Cooper Lighting Solutions

Doc No: 9850-000778-00



## Typical Schematic

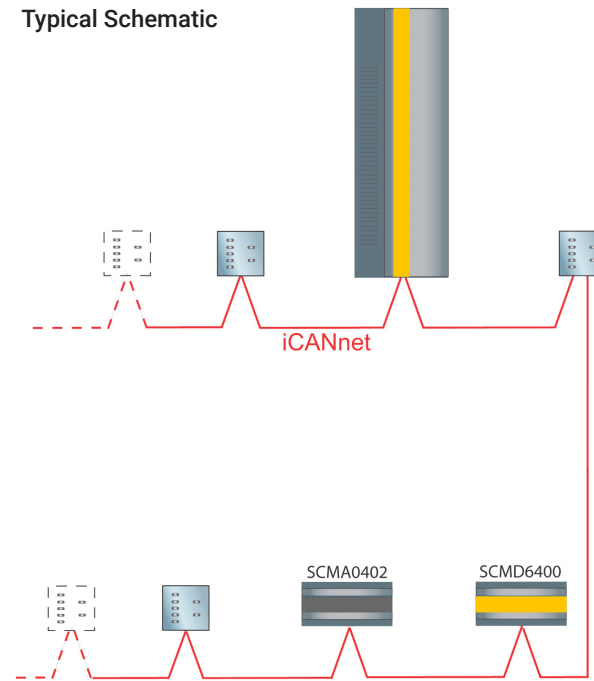

## Mounting & Installation

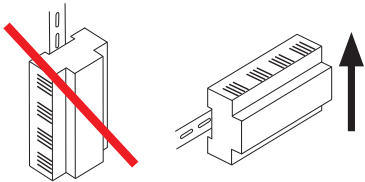

SCMA0402 must be mounted in a suitable enclosure to provide regulatory protection from electric shock hazard as well as protecting the iCANnet data network from tampering that could lead to reduced network security.

Ensure selected enclosure provides adequate cooling ventilation.

### Fixing to DIN rail

1. Fix top clips over DIN rail.
2. Pull down bottom clip using screwdriver.
3. Close module towards DIN rail.
4. Push up bottom clip to fix securely to DIN rail.

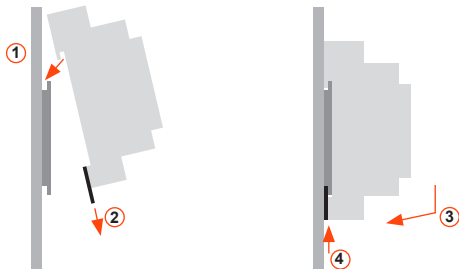

### Removing from DIN rail

1. Pull down bottom clip with screwdriver.
2. Lift module away from DIN rail.

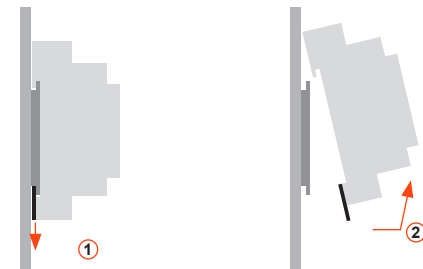

## Technical Data

### Electrical & Mechanical

Supply: 230VAC +/- 10%, 50/60 Hz  
Incoming terminals: maximum cable size: 2.5mm<sup>2</sup>  
Rating: Maximum 10A single phase @ 40°C  
Protection: Provided by installer  
Output channel load: Maximum 575W  
Load Types: incandescent, inductive, leading & trailing edge  
Terminal Sizes: 1 x 2.5mm<sup>2</sup> per channel

### Communications

Cable Specification: CAT5 FTP terminated with RJ45 connectors

### Safety

Ambient temperature: 2°C - 40°C  
Relative humidity: 5% - 80% max, non-condensing  
IP rating: IP20  
Installation: Installation must be carried out by a suitably qualified electrician

# SCMA0402

Adaptive Dimmer

## Typical Connection Diagram

	OFF	OFF	OFF	OFF	Auto 'Default'	<b>Universal dimmer mode:</b> The dimmer starts in trailing edge mode and switches over to leading edge mode if it recognizes an inductive load and back to trailing edge mode for capacitive load. The dimmer mode stays constant even after an interruption of the mains.
	OFF	OFF	ON	OFF	LED 0-100% Trailing Edge	<b>LED-lamp trailing edge, 0 to 100%:</b> The dimmer brings immediately the requested value between 0 and 100%. For retrofit LED-lamps and incandescent lamps.
	OFF	ON	ON	OFF	LED 0-100% Leading Edge	<b>LED-lamp leading edge, 0 to 100%:</b> The dimmer brings immediately the requested value between 0 and 100%. For retrofit LED-lamps, incandescent lamps.

**CAUTION**

**\*Avoid Channel Damage**  
If unsure of mode type, set DIP switches to Auto 'Default'

Channel Output Status

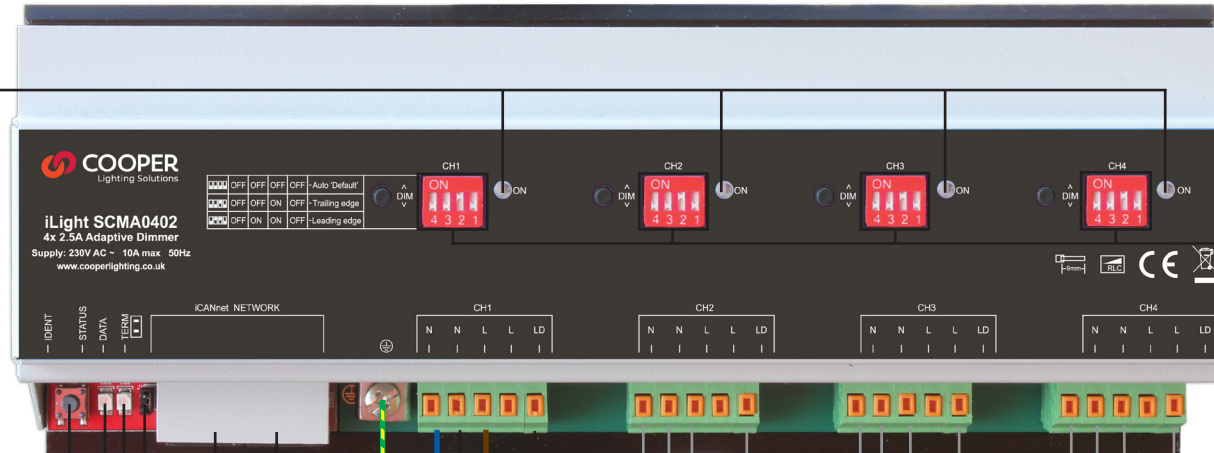

Ident Switch  
Status LED  
Data LED

**iLight Network Termination**  
Note: Remove termination jumper when SCMA is not the network end device

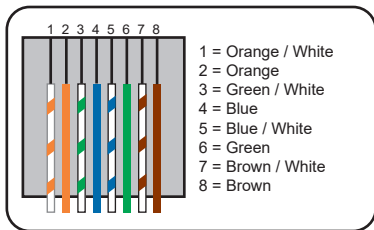

RJ45 x 2

**iCAN network connections via RJ45.**

Use CAT 5e/Cat6 for the interconnection of devices within an enclosure for speed and convenience.  
Use recommended network cable only for field network cabling.

### Ident Switch and LEDs

#### Normal Running Mode

Green LED flashes – device OK  
Red LED flashes when messages sent on network.

#### Device Identification

Press and release switch.  
Sending a message to identify the device on the network (red LED flashes).

#### iCANnet fault

Red LED is on constantly.

#### Entering Override Mode

Press and hold switch for 10 seconds.  
When in Override mode red and green LEDs flash simultaneously.

#### Override Mode

Switch press to toggle all circuits on then all circuits off

#### Exiting Override Mode

Press and hold switch for 10 seconds or cycle power.  
Green LED flashes.

#### Channel Output Status LEDs

Signify output level for each channel