

Installation Guide

SCMI0402

4 x 500W Triac Dimmer

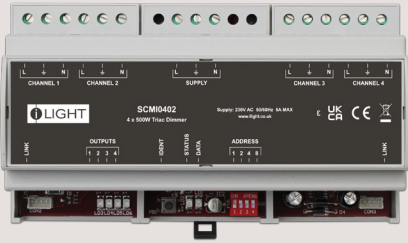

iLight

Usk House, Lakeside
Llantarnam Park,
Cwmbran,
NP44 3HD, UK

t: +44 (0)1923 495495
e: enquiries@iLight.co.uk
www.iLight.co.uk

EU Authorised Representative
Cooper Lighting Netherlands B.V.
High Tech Campus
HTC 48
Eindhoven
5656 AE



E&OE. iLight reserve the right to make changes to the equipment without prior notice.
© Signify Holding

Doc No: 9850-000808-01



Dimensions

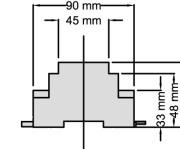
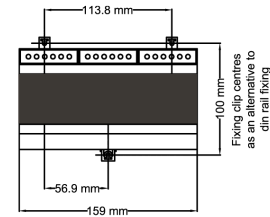

Typical Schematic

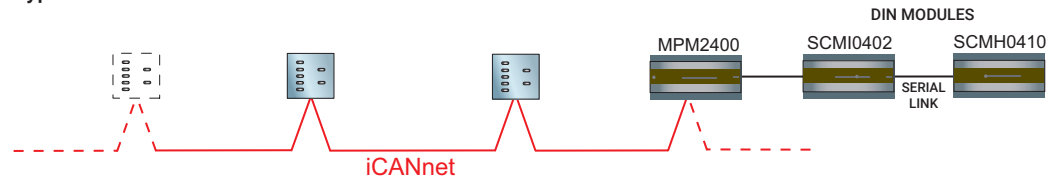

Mounting & Installation

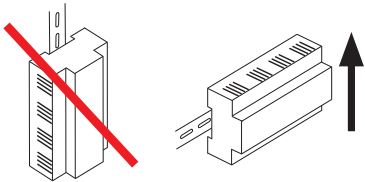

SCMI0402 must be mounted in a suitable enclosure to provide regulatory protection from electric shock hazard as well as protecting the iCANnet data network from tampering that could lead to reduced network security.

Ensure selected enclosure provides adequate cooling ventilation.

Fixing to DIN rail

1. Fix top clips over DIN rail.
2. Pull down bottom clip using screwdriver.
3. Close module towards DIN rail.
4. Push up bottom clip to fix securely to DIN rail.

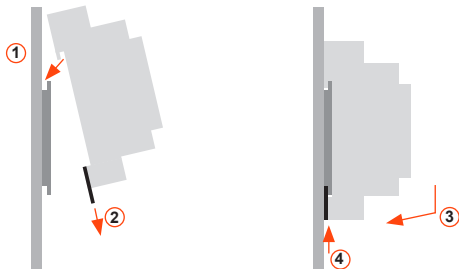

Removing from DIN rail

1. Pull down bottom clip with screwdriver.
2. Lift module away from DIN rail.

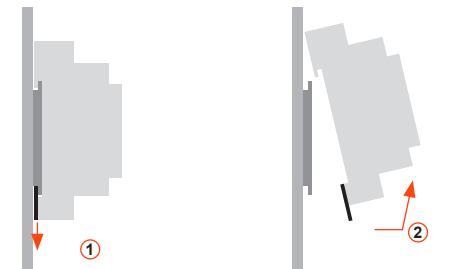

Technical Data

Electrical & Mechanical

Supply: 230VAC +/- 10%, 50/60 Hz
Incoming terminals: maximum cable size: 2.5mm²
Rating: Maximum 5A single phase @ 40°C
Protection: Provided by installer
Output channel load: Minimum 20W, maximum 500W per Heatsink
Load Types: Incandescent 230VAC lamps
Inductive wire-wound transformers (allow for 20% transformer losses) Leading edge electronic transformers and cold cathode lamps (consult iLight for true load guidance)
Switched outputs: Dimmed outputs can be configured as switches for non-dimmed loads.
Not suitable for switching discharge lamps.

Communications

SCMI0402 requires connection to MPM2400 primary controller to operate Module Link Connections
Use cable supplied with unit. See diagram for installation
Terminal Sizes:
Loads - maximum cable size: 1 x 2.5mm² or 2 x 1.5mm² per circuit

Safety

Ambient temperature: 2°C – 40°C
Relative humidity: 5% - 95% max, non-condensing
IP rating: IP20
Installation: Installation must be carried out by a suitably qualified electrician

SCMI0402

4 x 500W Triac Dimmer

Typical Connection Diagram

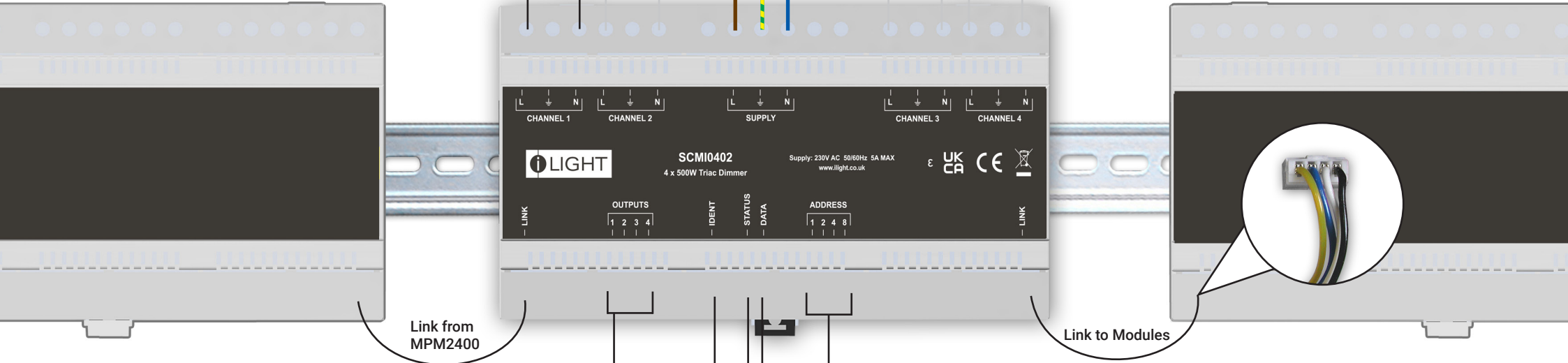

Ident Switch and LEDs

Normal Running Mode

Green LED flashes – device OK
Red LED flashes when messages sent on network.

Device Identification

Press and release switch.
Sending a message to identify the device on the network (red LED flashes).
Red LED flashes at 2Hz when the unit has an error.

Entering Override Mode

Press and hold switch for 10 seconds.
When in Override mode the green LED flashes twice as fast and the red LED shows the output state. ie red LED off denotes all outputs off, red LED on denotes all output on.

Override Mode

Short push of switch - all circuits on.
Short push of switch - all circuits off.

Exiting Override Mode

Press and hold switch for 10 seconds or cycle power. Green LED flashes.

Output LEDs

Signify output level for each channel

Ident Switch

Output Status

Data LED

Status LED

Address Switches

