

Installation Guide

MPM2400

Primary Processor Module

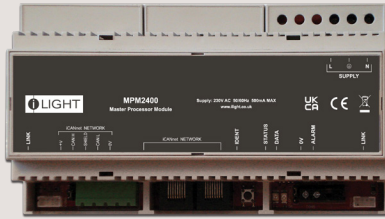

iLight

Usk House, Lakeside
Llantarnam Park,
Cwmbran,
NP44 3HD, UK

t: +44 (0)1923 495495
e: enquiries@iLight.co.uk
www.iLight.co.uk

EU Authorised Representative
Cooper Lighting Netherlands B.V.
High Tech Campus
HTC 48
Eindhoven
5656 AE

E&OE. iLight reserve the right to make changes to the equipment without prior notice.
© Signify Holding

Doc No: 9850-000802-01

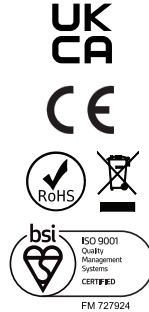

Dimensions

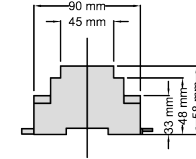
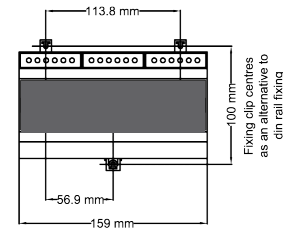

Typical Schematic

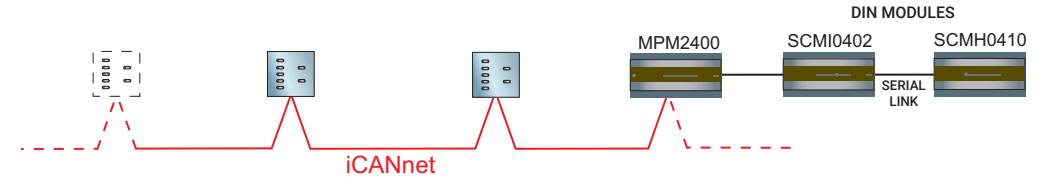

Mounting & Installation

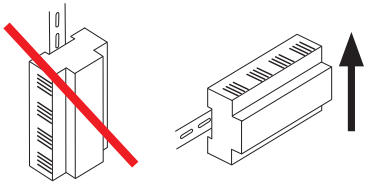

MPM2400 must be mounted in a suitable enclosure to provide regulatory protection from electric shock hazard as well as protecting the iCANnet data network from tampering that could lead to reduced network security.

Ensure selected enclosure provides adequate cooling ventilation.

Fixing to DIN rail

1. Fix top clips over DIN rail.
2. Pull down bottom clip using screwdriver.
3. Close module towards DIN rail.
4. Push up bottom clip to fix securely to DIN rail.

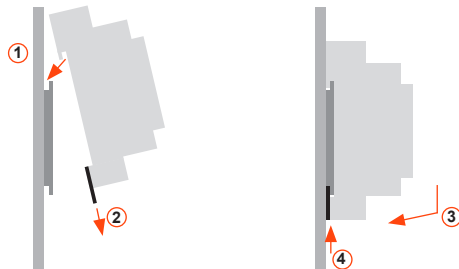

Removing from DIN rail

1. Pull down bottom clip with screwdriver.
2. Lift module away from DIN rail.

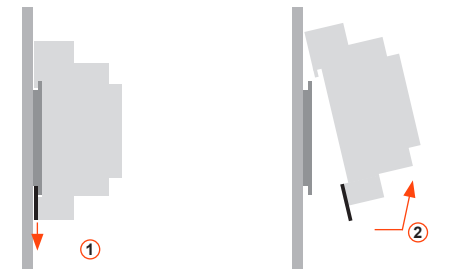

Technical Data

Electrical & Mechanical

Supply: 1A, 230VAC +/- 10%, 50/60 Hz. Max cable: 2.5mm²
Rating: Max 6A single phase @ 40°C
Protection: Provided by installer
Design verification as per IEC/EN 61439:
Equipment heat dissipation, current-dependent: 8.5W Max

Communications

Recommended Cable: iCANnet Cable for screw terminals or CAT5 FTP terminated with RJ45 connectors.
Serial Link Connections: Use cable supplied with unit. See diagram for installation
Alarm input: Max cable: 1.5mm², Max Length: 10m

Safety

Ambient temperature: +2C° to +40°C
Relative humidity: 5% to 80% max, non-condensing
IP rating: IP20
Installation: Installation must be carried out by a suitably qualified electrician

MPM2400

Primary Processor Module

Typical Connection Diagram

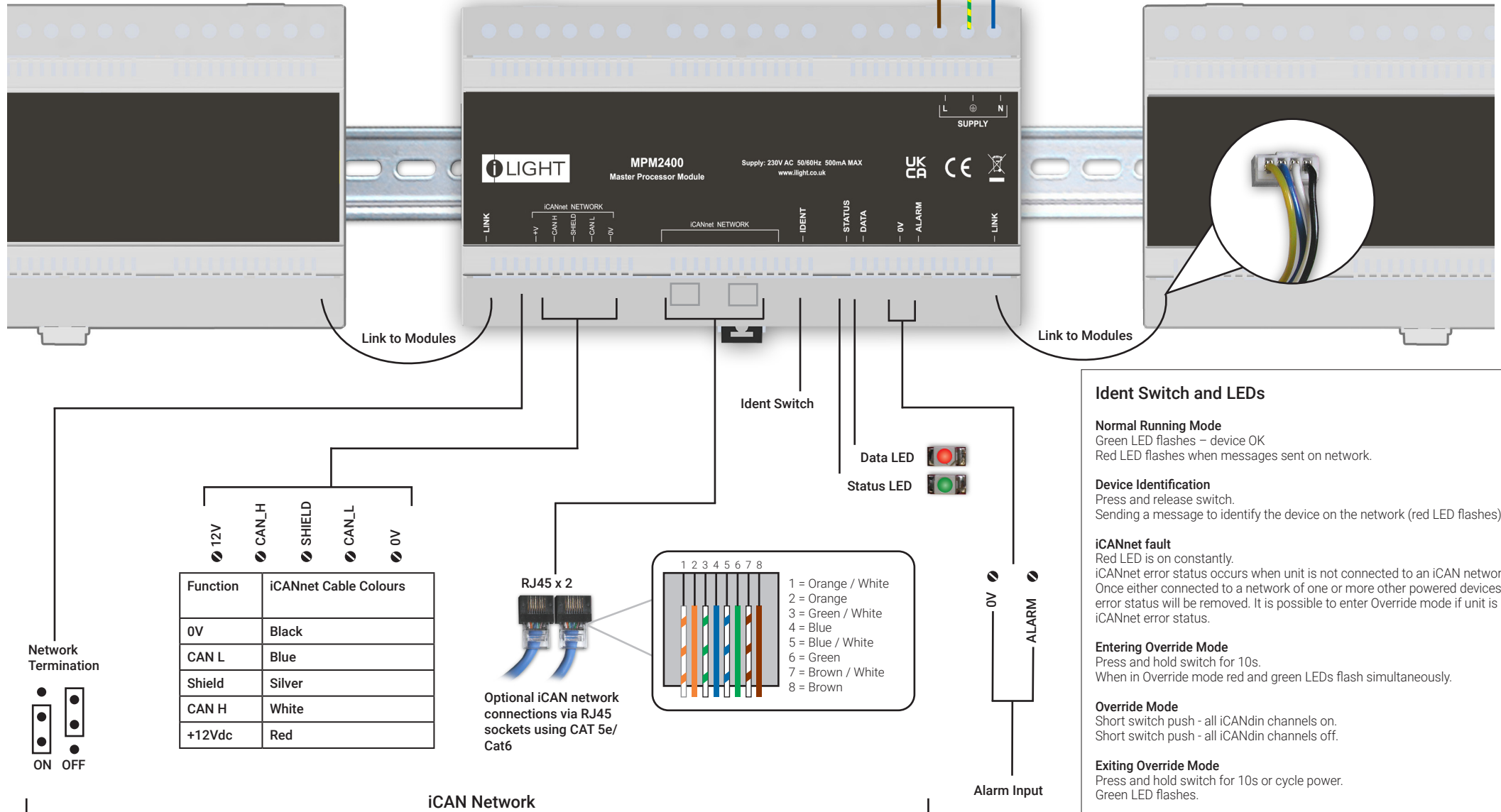

Ident Switch and LEDs

Normal Running Mode
Green LED flashes – device OK
Red LED flashes when messages sent on network.

Device Identification
Press and release switch.
Sending a message to identify the device on the network (red LED flashes).

iCANnet fault
Red LED is on constantly.
iCANnet error status occurs when unit is not connected to an iCAN network. Once either connected to a network of one or more other powered devices, the error status will be removed. It is possible to enter Override mode if unit is in iCANnet error status.

Entering Override Mode
Press and hold switch for 10s.
When in Override mode red and green LEDs flash simultaneously.

Override Mode
Short switch push - all iCANdin channels on.
Short switch push - all iCANdin channels off.

Exiting Override Mode
Press and hold switch for 10s or cycle power.
Green LED flashes.