

# Installation Guide

## SCMD2

2 Universe Addressable  
DALI Controller



### Eaton Lighting Systems

Usk House, Lakeside  
Llantarnam Park,  
Cwmbran,  
NP44 3HD, UK

T: +44 (0)1923 495495  
E: techsupportcc@eaton.com  
www.iLight.co.uk



E&OE. Changes to the products, to the information contained in this document, and to prices are reserved; so are errors and omissions. © Eaton

Document Number: 9850-000653-01

### Typical iCANdin Schematic

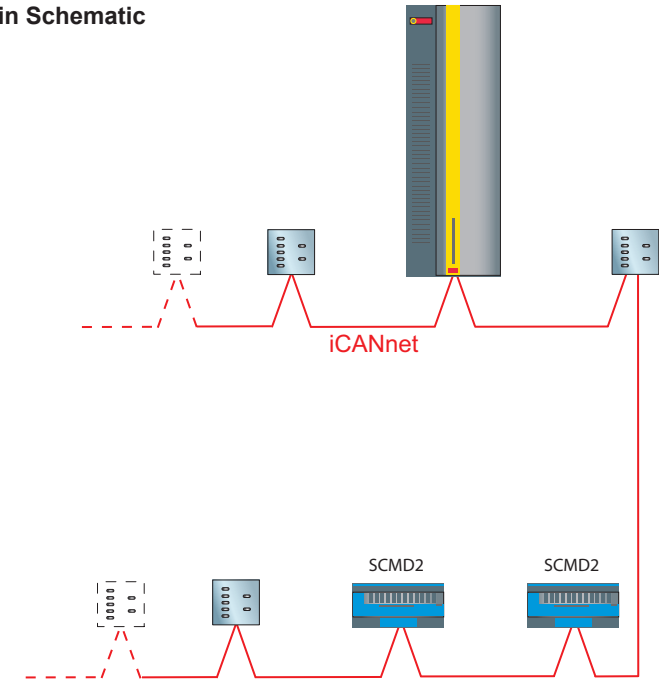

## ① Mounting

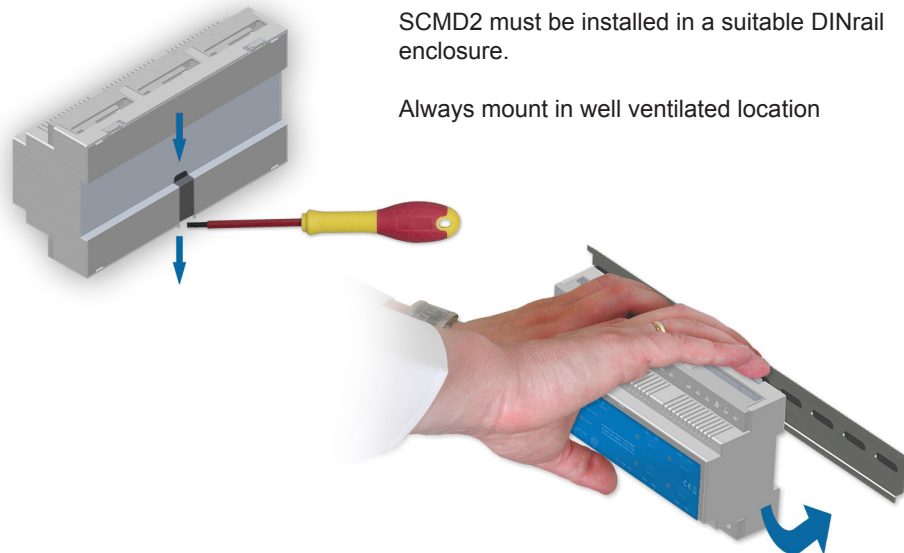

SCMD2 must be installed in a suitable DINrail enclosure.

Always mount in well ventilated location

## ②

### Mechanical

Weight: 0.35 kg

Operating temperature: +2°C to +50°C

Max storage temperature: +60°C

Humidity: +5 to 95% non-condensing

Environmental protection: IP20

Installation: Installation must be carried out by a suitably qualified electrician and installed in a suitable DINrail enclosure rated for the intended environment.

### Electrical

Supply: 100 - 230VAC +/- 10%, 50/60 Hz

Terminals max. wire size: 2.5mm<sup>2</sup>

iCANnet™ inputs/output: Screw terminals

DALI output screw terminals: Max wire size 2.5mm<sup>2</sup>

DALI signal: Nominal 16V, max current 250mA supplies to each loop

Terminals max wire size: 1 x 2.5mm<sup>2</sup> or 2 x 1.5mm<sup>2</sup> per circuit

Protection: Provided by installer

③

## SCMD2

2 Universe Addressable  
DALI Controller

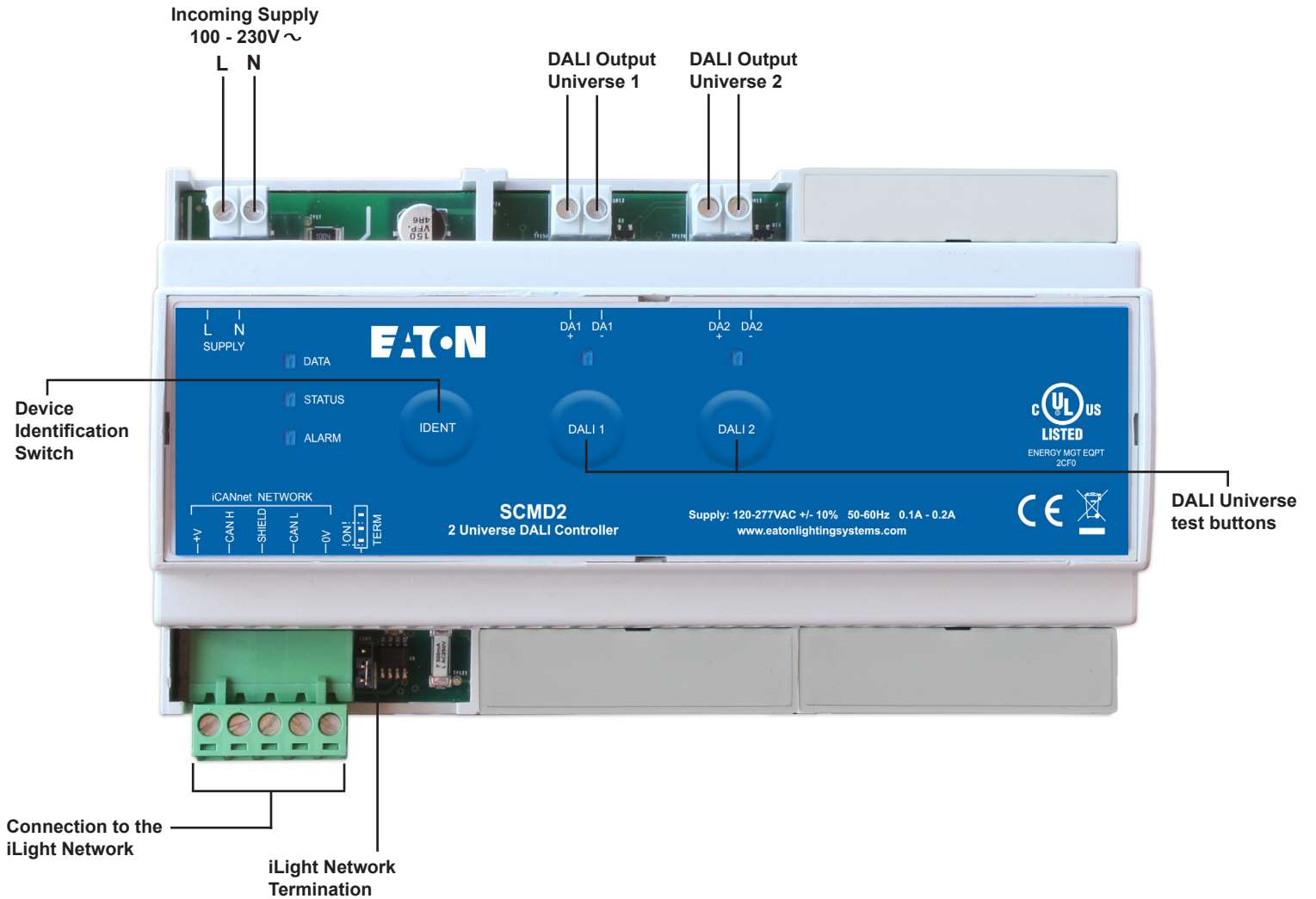

## ④ Device LEDs and Buttons

### Status LED

Green LED flashes – device OK

### Data LED

Red LED flashes when messages sent on network.

### Alarm LED

Red LED flashes for network initiated alarm

### Device Identification

Press and release switch.  
Sending a message to identify the device on the network (red Data LED flashes).

### DALI LEDs

Yellow LED flashes when messages sent on DALI bus  
Yellow LED solid on - short circuit on DALI bus

### DALI Universe Test buttons

10 second press to enter Test mode  
Sequential presses Broadcast all on all off  
10 second press to exit Test mode.