

Introduction

Welcome

The Revio wallstation from Cooper Controls artfully combines understated elegance with high functionality. Barely larger than a standard switchplate, this sleek, backlit panel allows you to instantly call up pre-programmed lighting scenes. The rotary dial can be used to adjust the intensity of a chosen scene. An optional infrared remote control allows similar functionality from anywhere within the room via the detector built into the front panel of the Revio wallstation. All control signals are transmitted to the source controller(s) using iCANNet connections. A range of standard inserts are available or a custom insert can be created.

Controls

Scene selection

- Press a scene button to select a scene (the button will illuminate).
- Turn the rotary dial to raise or lower the scene level.
- Use the on/off button (in the center of the rotary dial) to switch all lights off (the function of the button can also be altered to affect only certain areas). When the button is pressed again, the last selected scene will be resumed.

Zone function

Where certain buttons are programmed to control zones:

- Press a zone button to select a zone (the button will flash).
- Turn the rotary dial to raise or lower the zone level.
- Use the on/off button to switch the zone on and off.
- Press a scene button to override previous zone settings, unless ignore has been programmed for that particular zone.
- The zone function will timeout after five seconds.

Cleaner switch

On the underside of the front cover, there is a small concealed press switch. Press the switch to isolate the scene selectors for ten seconds. This action also sends a 'hello' message to the network to assist with device identification - this does not interfere with the operation of the wallstation or the rest of the system.

Supplied parts

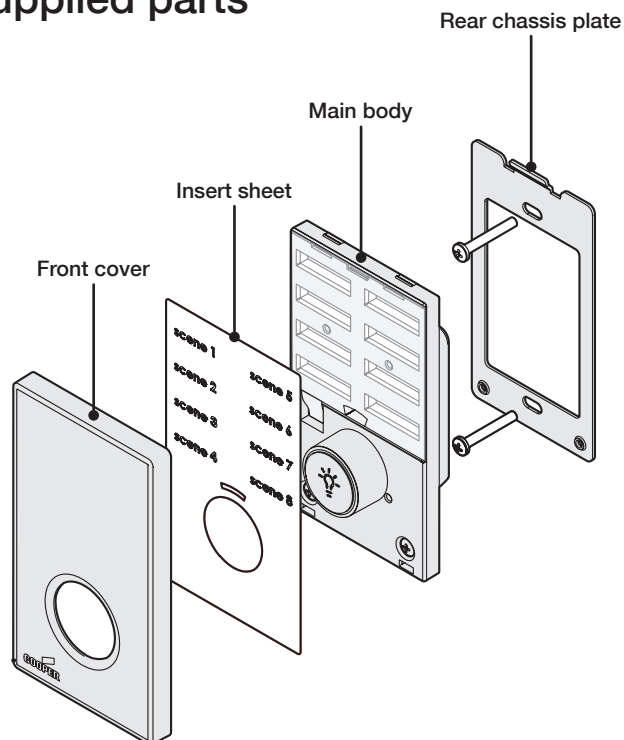

Dimensions

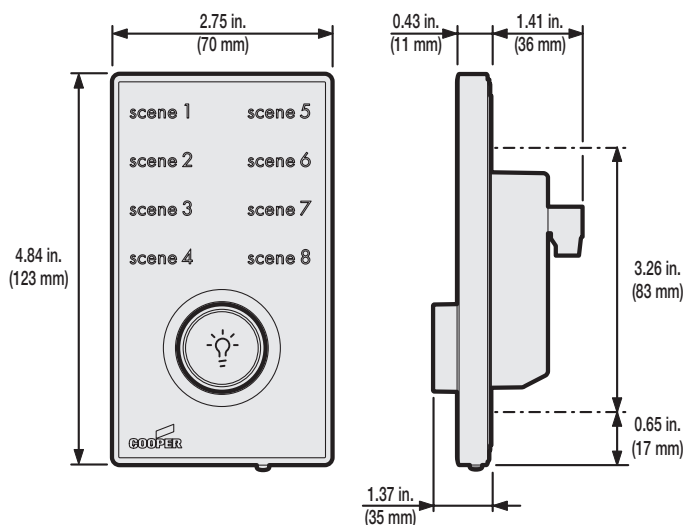

The Revio wallstation is intended to fit into a single gang US style wall box with a minimum internal depth of 2 in. (51 mm). Wall boxes available from Cooper Controls.

Disassembling the wallstation

1. On the underside of the front cover, beneath the rotary dial, locate the small central recess. Carefully insert a small implement (such as a pen or screwdriver) into the recess and lever the front cover gently away from the main body.

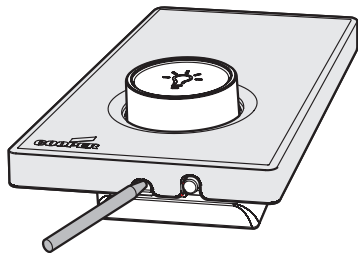

2. Unclip the front cover from the top of the main body.
3. With the front cover removed, lift off the insert sheet.

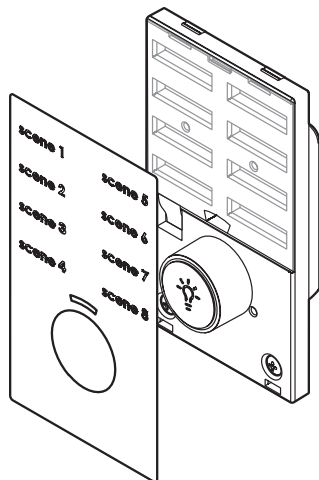

4. Remove the two retaining screws located just below the rotary dial and lift the base of the main body away from the rear chassis plate until it disengages.

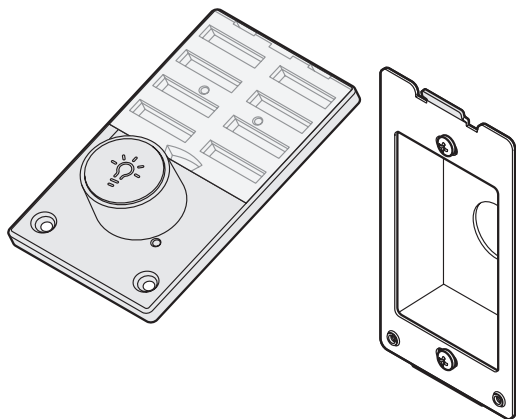

5. Store all removed parts safe from damage.

Fixing to a wallbox

The Revio wallstation is intended to fit into a single gang US style wall box with a minimum internal depth of 2 in. (51 mm).

With the Revio wallstation disassembled, use the two supplied long screws to secure the rear chassis plate to the wall box.

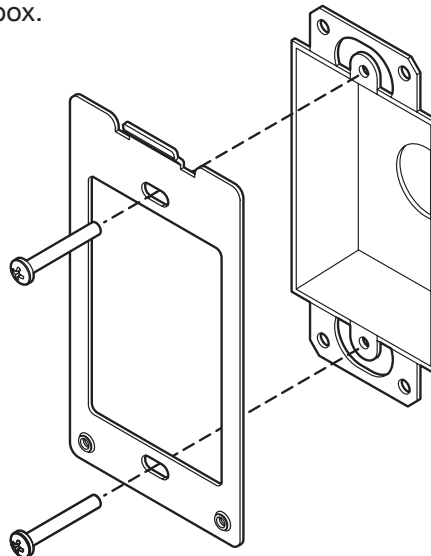

Control wiring

The Revio wallstation uses iCANnet connections to ensure reliable and responsive transfer of control signals between multiple devices.

Cable connections are made to a removable 5-way connector block located at the rear of the Revio wallstation main body:

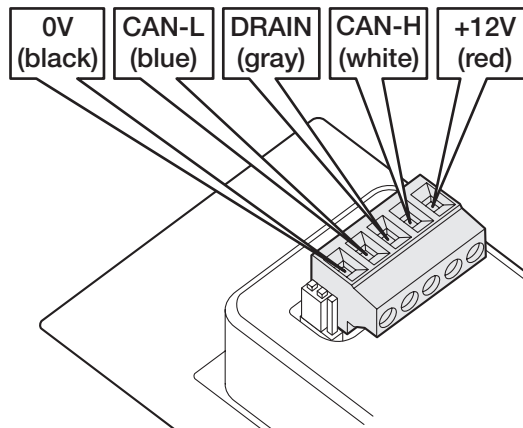

Cable type:

Cooper LCCNP (Non Plenum)
or Cooper LCCP (Plenum)
or Belden1502R (Non Plenum)
or 1502P (Plenum)

Maximum cable length:

1000m/3200ft

Devices per segment:

100 without a bridge

Termination

The iCANnet link is a 'daisy chain' protocol that requires termination on the devices located at either end of the chain.

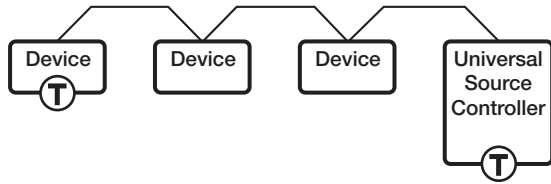

The Revio wallstation is supplied with termination enabled as standard. If the Revio wallstation is not connected as an end device in the chain, you need to disable termination.

To disable termination, move the jumper from the upper two pins to the lower two pins, as shown here:

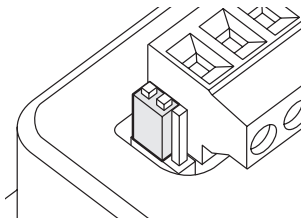

Termination on

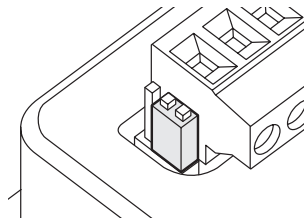

Termination off

Reassembling the wallstation

1. Locate the upper slot on the rear of the wallstation main body, place the upper slot onto the corresponding 'lip' of the rear chassis plate.

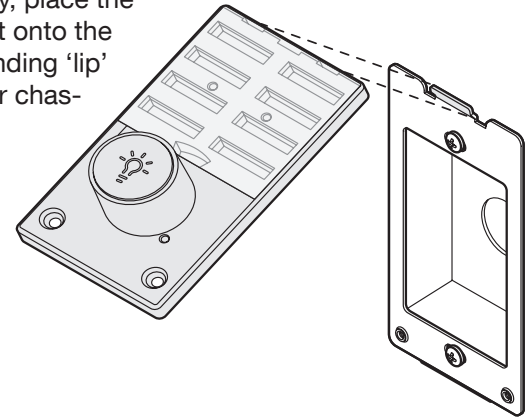

2. Angle the lower part of the main body down so that it fits closely against the rear chassis plate.
3. Insert and lightly tighten the two retaining screws.

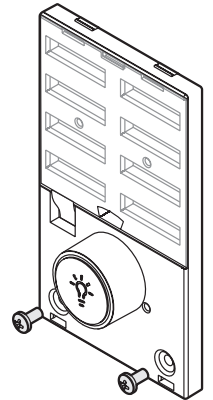

4. Place the insert sheet into position.

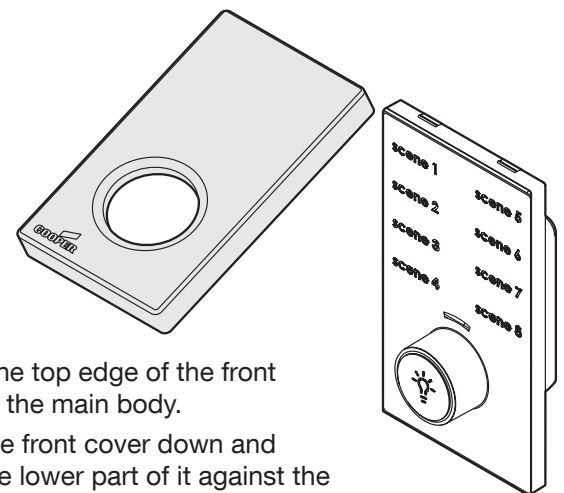

5. Attach the top edge of the front cover to the main body.
6. Angle the front cover down and press the lower part of it against the main body until it clicks into place.

Model numbers

Each model is specified using a part number in the following format:

CL V 4 4Z RL W IR T1

Cooper
iLumin
Revio

Number
of buttons
in first
column

Number of buttons
in second column.
Z denotes 'Zone'
function

Raise/Lower
(always fitted)

Insert color:
W - White
B - Black
G - Gray
V - Ivory

IR
Receiver

Insert text:

Blank Scene 1, Scene 2, etc.

T1 Preset 1, Preset 2, etc.

T2 General, Meeting, Seminar, Lecture

T3 Lunch, Cocktails, Dinner, Special

Ambient atmosphere requirements

Temperature 32°F to 104°F (0°C to +40°C)

Humidity 0 to 95% non-condensing

Document 73-888-00 IM8504 Iss.05

Cooper Controls
Unit 4 Enterprise Center, Penshurst,
Tonbridge, Kent, TN11 8BG, UK

 **COOPER** Controls