



# DALI

## DALI Control Panel Range

### Key Features

- Integrated DALI communication interface
- Draws power from the DALI communications bus to simplify wiring
- Suitable for standard single gang UK wall box
- Available in Black or White finishes
- Standard or custom engraving on buttons
- CE compliant to all relevant standards
- Designed and manufactured to ISO9001:2015 standards

### Overview

DALI control panels are available in 4 configurations which include the use of a large on/off button control with associated up/down adjustments and a choice of large and small buttons. Individual buttons have backlight indicator lights and strong tactile feedback. There is also a custom button engraving service making DALI control panels fully flexible to meet the needs of your project.

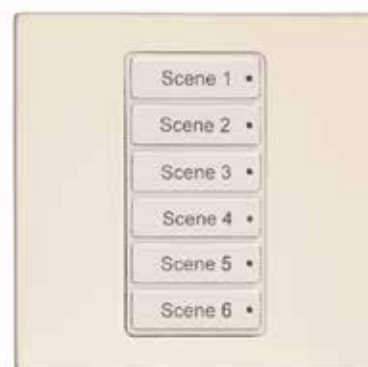

## Button Functions

Scene selection  
Scene raise/lower  
Channel raise/lower  
Toggle on/off  
Toggle raise/lower  
True off  
Open/close (for curtains or blinds)  
Raise/lower (for motorized screens)  
Task (start/stop a sequence)

## Mechanical Data

Buttons include scene, raise, lower, on, off functionality.

Choice of large or small button caps

Standard or custom engraving on buttons

Tap on/off feature to override fade time

All plastic construction with a separate snap-on surround

Suitable for standard single gang UK wall box

## Electrical Data

DALI Input Voltage:  
9.5 VDC - 22.5 VDC supplied by the DALI communication bus

DALI Current:  
Draw 3.75 mA per device

Temperature Range: 0°C to +40°C

Humidity: 0% - 95% non condensing

DALI Wiring:  
Two-wire, non-polarized control

## Typical Schematic

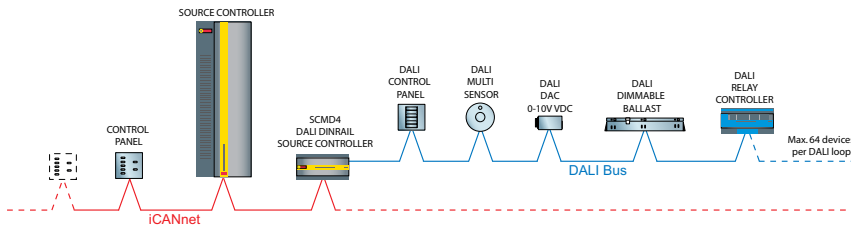

## Dimensions

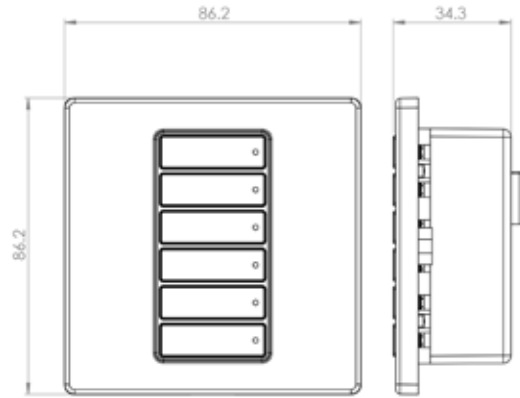

## Button Configurations

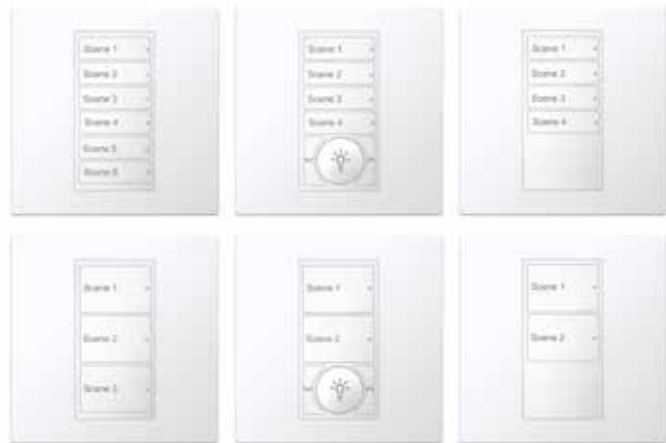

## Contact your local Eaton office

T: +44 (0)1923 495495 F: +44 (0)1923 228796  
E: enquiries@iLight.co.uk www.iLight.co.uk

**Eaton Lighting Systems**  
20 Greenhill Crescent,  
Watford Business Park,  
Watford, Herts, WD18 8JA. UK  
eatonlightingsystems.com

© 2018 Eaton  
All Rights Reserved

Document No: DALI Rev3 0318

Changes to the products, to the information contained in this document, and to prices are reserved; so are errors and omissions.

Eaton is a registered trademark.

All other trademarks are property of their respective owners.

**EATON**

Powering Business Worldwide

CE

